



Serie/*Series*

1000

RACCORDI A CALZAMENTO
PUSH-ON FITTINGS

Caratteristiche Tecniche | Technical Characteristics

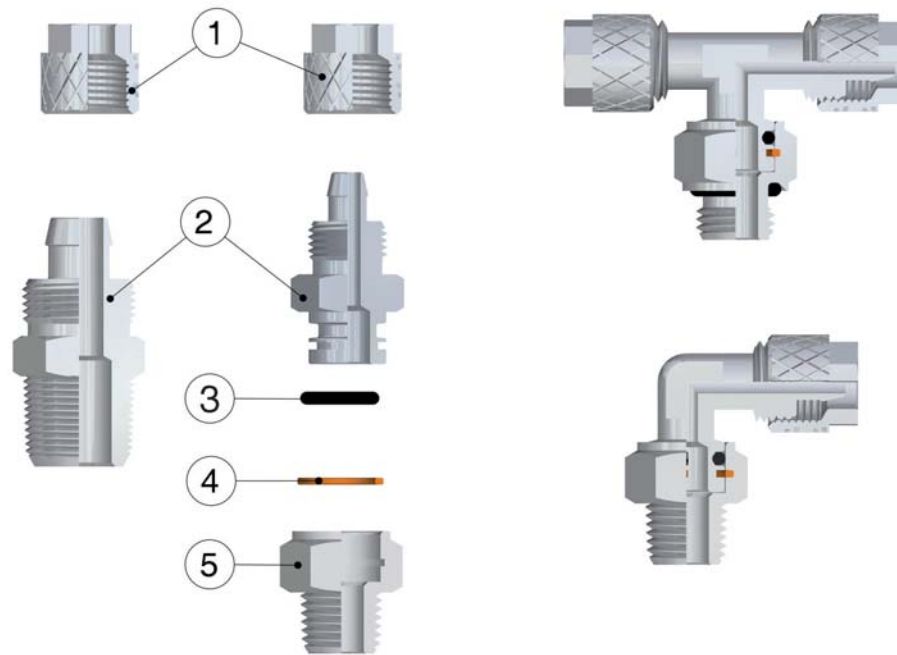

Materiali e Componenti | Component Parts and Materials

- | | |
|--------------------------------|----------------------------|
| 1 Dado in Ottone Nichelato | 1 Nickel-plated Brass Nut |
| 2 Corpo in Ottone Nichelato | 2 Nickel-plated Brass Body |
| 3 Guarnizione O-Ring in NBR 70 | 3 NBR 70 O-RING Seals |
| 4 Seeger in Bronzo | 4 Bronze Seeger |
| 5 Basetta in ottone Nichelato | 5 Nickel-plated Brass Base |

IN NESSUN CASO I RACCORDI "GIREVOLI" DEVONO ESSERE IMPIEGATI COME GIUNTI ROTANTI.
 UNDER NO CIRCUMSTANCES, THE "SWIVEL" FITTINGS CAN BE USED AS REVOLVING JOINTS.

Pressioni e Temperature | Pressures and Temperatures

Pressioni e temperature sono determinate dal tipo di tubo impiegato, pertanto tali valori sono da definirsi in base alle caratteristiche del tubo stesso.

Temperatures and Pressures

The working pressures and working temperatures depend on which type of tube is used, for this reason, the values must be determined in accordance with the tube's features.

Per i raccordi nella versione "girevole" i valori sono:
 For the "swivel" fittings, the values are:

Pressioni | Pressures

Pressione minima / Minimum pressure: **-0.99 bar (-0.099 MPa)**
 Pressione massima / Maximum pressure: **15 bar (1.5 MPa)**

Temperature | Temperatures

Temperatura minima / Minimum temperature: **-20 °C**
 Temperatura massima / Maximum temperature: **+80 °C**

Filettature | Threads

Gas conica conforme ISO 7.1, BS 21, DIN 2999 / Tapered gas in conformity with ISO 7.1, BS 21, DIN 2999.
 Gas cilindrica conforme ISO 228 Classe A / Parallel gas in conformity with ISO 228 Class A.
 Metrica conforme ISO R/262 / Metric in conformity with ISO R/262.

Tubi di collegamento | Connection Tubes

Tubi in materiale plastico:
PA6, PA11, PA 12, Polietilene, Poliuretano;ecc. PVC intrecciato.
 Plastic tubes:
 PA6, PA11, PA12, Polyethylene, Polyurethane, Braided PVC.

Fluidi compatibili | Fluids

Aria compressa. Fluidi e liquidi a bassa pressione compatibili con il tipo di accoppiamento.
 Compressed air. Fluids and liquids at low pressure compatible with the connection.

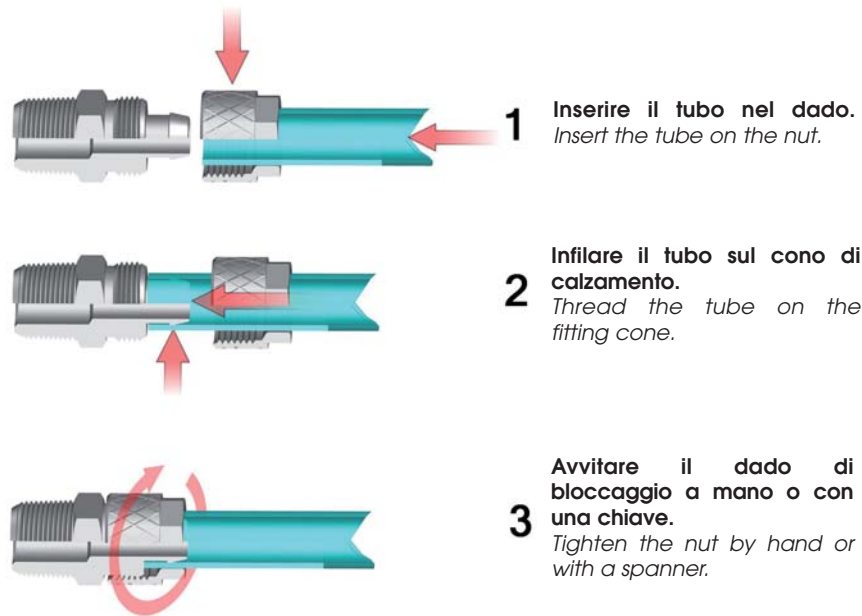

COME ORDINARE

Tutti gli articoli standard della Serie 1000 subiscono un trattamento superficiale di NICHELATURA.

Per formulare un ordine é sufficiente specificare ARTICOLO, MISURA, QUANTITA'.

HOW TO ORDER

All the standard items of the 1000 series undergo to a surface treatment of nickel plating.

To order simply specify the ARTICLE CODE, SIZE and QUANTITY.

1115

RACCORDO A L ORIENTABILE MASCHIO CILINDRICO
ORIENTING ELBOW MALE ADAPTOR (PARALLEL)

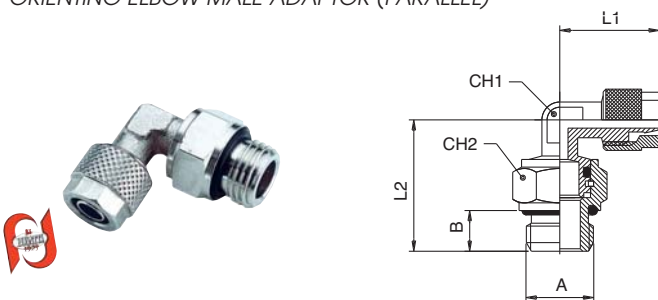

Tubo/Tube	A	B	L1	L2	CH1	CH2	Conf. Pack.
4/2.7 - 1/8	6	20	22	8	13	50	
6/4 - 1/8	6	20.6	22	8	13	50	
6/4 - 1/4	8	20.6	26	8	16	25	
8/6 - 1/8	6	21.6	21.6	9	13	25	
8/6 - 1/4	8	23.1	26.5	9	16	25	
10/8 - 1/4	8	24	27.5	11	16	25	

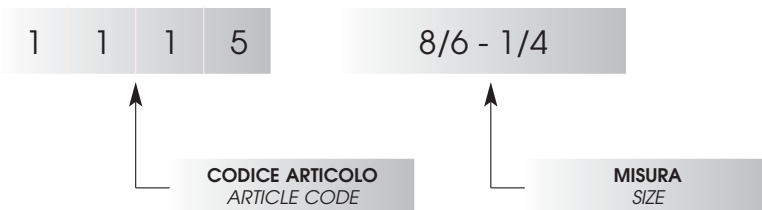

1000

RACCORDO DIRITTO MASCHIO CONICO - STRAIGHT MALE ADAPTOR (TAPER)

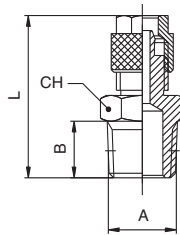

Tube/Tube	A	B	L	CH	Conf. Pack.
4/2.7 - 1/8	7.5	23.5	12	50	
5/3 - 1/8	7.5	23	12	50	
6/4 - 1/8	7.5	25.6	12	50	
6/4 - 1/4	11	29.6	14	50	
6/4 - 3/8	11.5	30	17	25	
8/6 - 1/8	7.5	26.9	14	50	
8/6 - 1/4	11	30.9	14	50	
8/6 - 3/8	11.5	31.4	17	25	
8/6 - 1/2	14	34	22	25	
10/8 - 1/8	7.5	29	14	50	
10/8 - 1/4	11	33	14	25	
10/8 - 3/8	11.5	33.5	17	25	
10/8 - 1/2	14	36.5	22	25	
12/10 - 3/8	11.5	35	17	25	
12/10 - 1/2	14	38	22	25	
15/12.5 - 1/2	14	40	22	25	

1010

RACCORDO DIRITTO ORIENTABILE MASCHIO CONICO - ORIENTING STRAIGHT MALE ADAPTOR (TAPER)

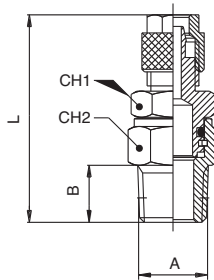

Tube/Tube	A	B	L	CH1	CH2	Conf. Pack.
6/4 - 1/8	7.5	33.5	12	13	50	
6/4 - 1/4	11	40	14	15	50	
8/6 - 1/8	7.5	33.5	12	13	50	
8/6 - 1/4	11	40	14	15	25	
10/6.5 - 1/4	11	41	14	15	25	
10/8 - 1/4	11	41	14	15	25	
12/8 - 3/8	11.5	43.5	17	17	25	
12/10 - 3/8	11.5	43.5	17	17	25	

Misure specifiche per tubi in POLIURETANO.
Particular sizes for the POLYURETHANE tubing.

Per tubo in POLIURETANO da 8/5 consigliamo l'utilizzo della nostra misura standard 8/6.

For the POLYURETHANE tube 8/5 we suggest to use the standard size 8/6.

1015

RACCORDO DIRITTO ORIENTABILE MASCHIO CILINDRICO - ORIENTING STRAIGHT MALE ADAPTOR (PARALLEL)

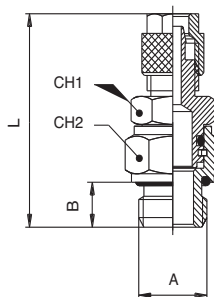

Tube/Tube	A	B	L	CH1	CH2	Conf. Pack.
6/4 - 1/8	6	34	12	13	50	
6/4 - 1/4	8	38	14	16	50	
8/6 - 1/8	6	34	12	13	50	
8/6 - 1/4	8	38	14	16	25	
10/6.5 - 1/4	8	40	14	16	25	
10/8 - 1/4	8	39	14	16	25	
12/8 - 3/8	9	42.5	17	18	25	
12/10 - 3/8	9	42.5	17	18	25	

Misure specifiche per tubi in POLIURETANO.
Particular sizes for the POLYURETHANE tubing.

Per tubo in POLIURETANO da 8/5 consigliamo l'utilizzo della nostra misura standard 8/6.

For the POLYURETHANE tube 8/5 we suggest to use the standard size 8/6.

1020

RACCORDO DIRITTO MASCHIO CILINDRICO - STRAIGHT MALE ADAPTOR (PARALLEL)

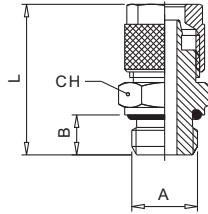

Tube/Tube	A	B	L	CH	Conf. Pack.
4/2.7 - 1/8	6	23	13	50	
5/3 - 1/8	6	25.1	13	50	
6/4 - 1/8	6	25.1	13	50	
6/4 - 1/4	8	28.1	16	50	
6/4 - 3/8	9	29.1	19	25	
6/4 - 1/2	10	32	24	25	
8/6 - 1/8	6	26.4	14	50	
8/6 - 1/4	8	29.4	16	25	
8/6 - 3/8	9	30.4	19	25	
8/6 - 1/2	10	32	24	25	
10/8 - 1/8	6	28.5	14	25	
10/8 - 1/4	8	31.5	16	25	
10/8 - 3/8	9	32.5	19	25	
10/8 - 1/2	10	34.5	24	25	
12/10 - 3/8	9	34	19	25	
12/10 - 1/2	10	36	24	25	
15/12.5 - 1/2	10	38	24	25	

1021

RACCORDO DIRITTO MASCHIO CON FILETTATURE METRICHE - STRAIGHT MALE ADAPTOR WITH METRIC THREAD

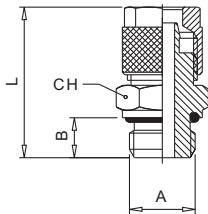

Tube/Tube	A	B	L	CH	Conf. Pack.
4/2.7 - M5	4	20.5	8	50	
4/2.7 - M6	5	21.5	8	50	
5/3 - M5	4	23.1	8	50	
5/3 - M6	5	23.1	8	50	
6/4 - M5	4	23.1	8	50	
6/4 - M6	5	23.1	8	50	
6/4 - M12x1	8	28.1	15	25	
6/4 - M12x1.25	8	28.1	15	25	
6/4 - M12x1.5	8	28.1	15	25	

1025

RACCORDO DIRITTO MASCHIO CONICO + DADO CON MOLLA - STRAIGHT MALE ADAPTOR (TAPER) + NUT AND SPRING

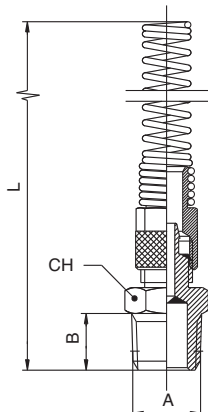

Tube/Tube	A	B	L	CH	Conf. Pack.
6/4 - 1/8	7.5	108	12	25	
6/4 - 1/4	11	112.5	14	25	
8/6 - 1/8	7.5	113.5	14	25	
8/6 - 1/4	11	118	14	25	
8/6 - 3/8	11.5	119	17	25	
8/6 - 1/2	14	121	22	25	
10/8 - 1/8	7.5	122	14	25	
10/8 - 1/4	11	126	14	25	
10/8 - 3/8	11.5	127	17	25	
10/8 - 1/2	14	130	22	25	
12/10 - 3/8	11.5	134	17	25	
12/10 - 1/2	14	137	22	25	

1026

RACCORDO DIRITTO ORIENTABILE MASCHIO CONICO + DADO CON MOLLA - ORIENTING STRAIGHT MALE ADAPTOR (TAPER) + NUT AND SPRING

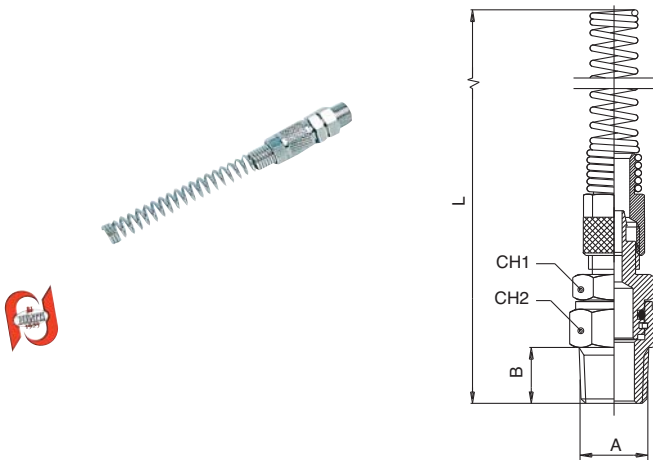

Tubo/Tube	A	B	L	CH1	CH2	Conf. Pack.
6/4 - 1/8		7.5	117.5	12	13	25
6/4 - 1/4		11	121	14	15	25
8/6 - 1/8		7.5	121	12	13	25
8/6 - 1/4		11	128	14	15	25
10/6.5 - 1/4		11	135	14	15	25
10/8 - 1/4		11	136	14	15	25
12/8 - 3/8		11.5	144	17	17	25
12/10 - 3/8		11.5	144	17	17	25

Misure specifiche per tubi in POLIURETANO.
Particular sizes for the POLYURETHANE tubing.

Per tubo in POLIURETANO da 8/5 consigliamo l'utilizzo della nostra misura standard 8/6.

For the POLYURETHANE tube 8/5 we suggest to use the standard size 8/6.

1027

RACCORDO DIRITTO ORIENTABILE MASCHIO CILINDRICO + DADO CON MOLLA - ORIENTING STRAIGHT MALE ADAPTOR (PARALLEL) + NUT AND SPRING

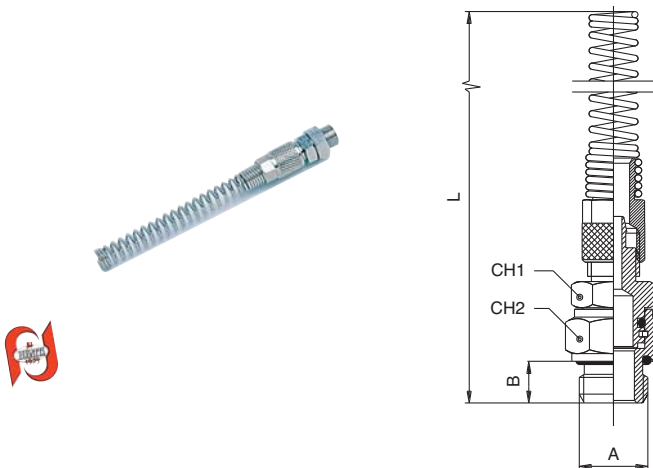

Tubo/Tube	A	B	L	CH1	CH2	Conf. Pack.
6/4 - 1/8		6	116	12	13	25
6/4 - 1/4		8	121	14	16	25
8/6 - 1/8		6	122	12	13	25
8/6 - 1/4		8	126	14	16	25
10/6.5 - 1/4		8	134	14	16	25
10/8 - 1/4		8	134	14	16	25
12/8 - 3/8		9	143	17	18	25
12/10 - 3/8		9	142	17	18	25

Misure specifiche per tubi in POLIURETANO.
Particular sizes for the POLYURETHANE tubing.

Per tubo in POLIURETANO da 8/5 consigliamo l'utilizzo della nostra misura standard 8/6.

For the POLYURETHANE tube 8/5 we suggest to use the standard size 8/6.

1028

RACCORDO DIRITTO MASCHIO CILINDRICO + DADO CON MOLLA - STRAIGHT MALE ADAPTOR (PARALLEL) + NUT AND SPRING

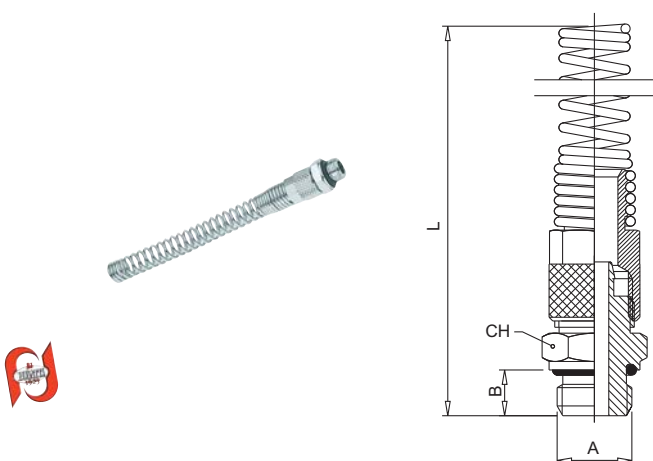

Tubo/Tube	A	B	L	CH	Conf. Pack.
6/4 - 1/8		6	109	13	25
6/4 - 1/4		8	111	16	25
6/4 - 3/8		9	112	19	25
6/4 - 1/2		10	114	24	25
8/6 - 1/8		6	114	14	25
8/6 - 1/4		8	116.5	16	25
8/6 - 3/8		9	117.5	19	25
8/6 - 1/2		10	119.5	24	25
10/8 - 1/8		6	121.5	14	25
10/8 - 1/4		8	125.5	16	25
10/8 - 3/8		9	125.5	19	25
10/8 - 1/2		10	128.5	24	25
12/10 - 3/8		9	133	19	25
12/10 - 1/2		10	134.5	24	25

1029

RACCORDO DIRITTO MASCHIO CON FILETTATURE METRICHE + DADO CON MOLLA - STRAIGHT MALE ADAPTOR WITH METRIC THREAD + NUT AND SPRING

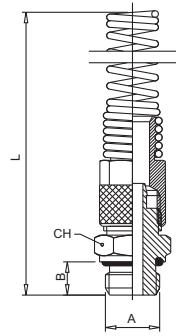

Tubo/Tube	A	B	L	CH	P	Conf. Pack.
6/4 - M12x1		8	111	15		25
6/4 - M12x1.25		8	111	15		25
6/4 - M12x1.5		8	111	15		25



1030

RACCORDO DIRITTO FEMMINA - STRAIGHT FEMALE ADAPTOR

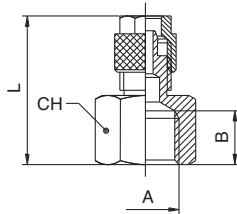

Tubo/Tube	A	B	L	CH		Conf. Pack.
6/4 - 1/8		8.5	23.3	14		50
6/4 - 1/4		11	27	17		50
6/4 - 3/8		11.5	28	22		25
8/6 - 1/8		8	24.7	14		50
8/6 - 1/4		11	28.7	17		25
8/6 - 3/8		11.5	29.2	22		25
8/6 - 1/2		15.5	33	24		25
10/8 - 1/4		11	30.5	17		25
10/8 - 3/8		11.5	31	22		25
10/8 - 1/2		15.5	34.5	24		25
12/10 - 3/8		11.5	32.5	22		25



1035

RACCORDO DIRITTO FEMMINA + DADO CON MOLLA - STRAIGHT FEMALE ADAPTOR + NUT AND SPRING

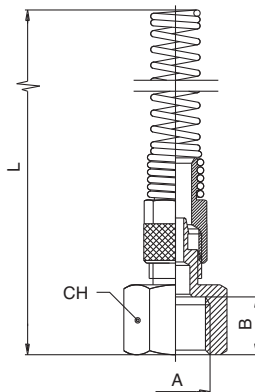

Tubo/Tube	A	B	L	CH		Conf. Pack.
6/4 - 1/8		8.5	106	14		25
6/4 - 1/4		11	109	17		25
6/4 - 3/8		11.5	110	22		25
8/6 - 1/8		8	112	14		25
8/6 - 1/4		11	115.5	17		25
8/6 - 3/8		11.5	116	22		25
8/6 - 1/2		15.5	119.5	24		25
10/8 - 1/4		11	123	17	2.060 / 1.06	25
10/8 - 3/8		11.5	124.5	22		25
10/8 - 1/2		15.5	128.5	24		25
12/10 - 3/8		11.5	131	22		25



1040

RACCORDO DIRITTO INTERMEDIO - STRAIGHT CONNECTOR

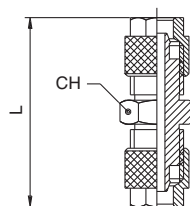

Tubo/Tube	L	CH	Conf. Pack.
4/2.7	27.5	8	50
5/3	31.7	8	50
6/4 - 5/3	32.2	12	50
6/4	32.2	12	50
8/6 - 6/4	33.5	12	25
8/6	34.8	12	25
10/8 - 6/4	35.6	14	25
10/8 - 8/6	36.9	14	25
10/8	39	14	25
12/10	43	17	25
15/12.5	47	22	25



1050

RACCORDO INTERMEDIO DI ATTRAVERSAMENTO - BULKHEAD CONNECTOR

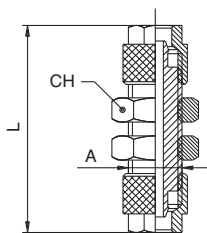

Tubo/Tube	A	L	CH	Conf. Pack.
4/2.7 - M6x0.5		35	10	50
5/3 - M7x0.75		35	10	50
6/4x5/3 - M10x1		45.5	14	50
6/4 - M10x1		45.5	14	25
8/6x6/4 - M12x1		47.3	17	25
8/6 - M12x1		48.4	17	25
10/8x6/4 - M14x1		49.8	17	25
10/8x8/6 - M14x1		51.2	17	25
10/8 - M14x1		52	17	25
12/10 - M16x1		57	19	25
15/12.5 - M20x1		59	24	25



1100

RACCORDO A L MASCHIO CONICO - ELBOW MALE ADAPTOR (TAPER)

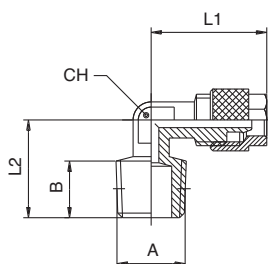

Tubo/Tube	A	B	L1	L2	CH	Conf. Pack.
4/2.7 - 1/8	7.5	19.5	15	8	50	
5/3 - 1/8	7.5	19.5	15	8	50	
6/4 - 1/8	7.5	19.5	15	8	50	
6/4 - 1/4	11	20.6	19	8	50	
6/4 - 3/8	11.5	21	21	9	25	
8/6 - 1/8	7.5	19.9	16.5	9	50	
8/6 - 1/4	11	21.9	19	9	50	
8/6 - 3/8	11.5	23.4	21	9	25	
8/6 - 1/2	14	26	28	16	25	
10/8 - 1/8	7.5	25	18	11	25	
10/8 - 1/4	11	24	22	11	25	
10/8 - 3/8	12.5	25.5	22.5	11	25	
10/8 - 1/2	14	28	28	16	25	
12/10 - 3/8	11.5	27	22.5	13	25	
12/10 - 1/2	14	30	28	16	25	
15/12.5 - 1/2	14	31.5	28	16	25	



1101

RACCORDO A L CON FILETTATURE METRICHE - ELBOW MALE ADAPTOR WITH METRIC THREAD

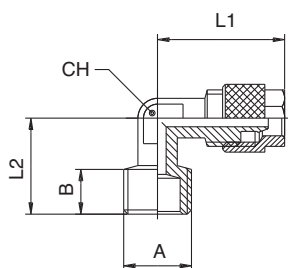

Tubo/Tube	A	B	L1	L2	CH	Conf. Pack.
6/4 - M12x1	11	20.6	19	8	25	
6/4 - M12x1.25	11	20.6	19	8	25	
6/4 - M12x1.5	11	20.6	19	8	25	



1110

RACCORDO A L ORIENTABILE MASCHIO CONICO - ORIENTING ELBOW MALE ADAPTOR (TAPER)

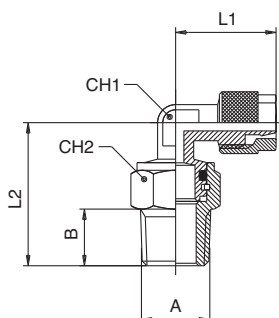

Tubo/Tube	A	B	L1	L2	CH1	CH2	Conf. Pack.
4/2.7 - 1/8	7.5	20	22.5	8	13	50	
6/4 - 1/8	7.5	20.6	22.5	8	13	50	
6/4 - 1/4	11	20.6	28	8	15	25	
8/6 - 1/8	7.5	21.6	22.5	9	13	25	
8/6 - 1/4	11	23.1	28.5	9	15	25	
10/8 - 1/4	11	24	30.5	11	15	25	



1115

RACCORDO A L ORIENTABILE MASCHIO CILINDRICO - ORIENTING ELBOW MALE ADAPTOR (PARALLEL)

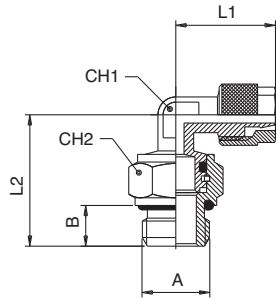

Tube/Tube	A	B	L1	L2	CH1	CH2	Conf. Pack.
4/2.7 - 1/8		6	18.5	22	8	13	50
6/4 - 1/8		6	20.6	22	8	13	50
6/4 - 1/4		8	20.6	26	8	16	25
8/6 - 1/8		6	21.6	21.6	9	13	25
8/6 - 1/4		8	23.1	26.5	9	16	25
10/8 - 1/4		8	24	27.5	11	16	25

1120

RACCORDO A L FEMMINA - ELBOW FEMALE ADAPTOR

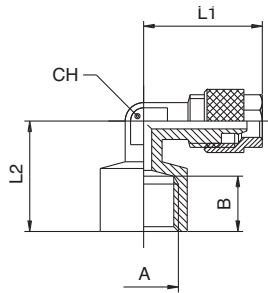

Tube/Tube	A	B	L1	L2	CH	Conf. Pack.
5/3 - 1/8		8.5	20.6	18	8	50
6/4 - 1/8		8.5	20.6	18	8	50
6/4 - 1/4		10.5	21	21	9	25
8/6 - 1/8		8.5	21.9	19	9	25
8/6 - 1/4		10.5	23.4	21	9	25
10/8 - 1/4		10.5	25.5	22.5	11	25
10/8 - 3/8		11.5	28	27	16	25

1130

RACCORDO A L INTERMEDIO - ELBOW CONNECTOR

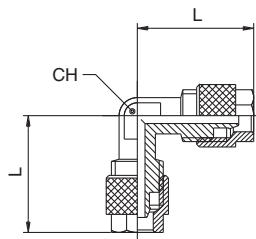

Tube/Tube	L	CH	Conf. Pack.
4/2.7	20	8	50
5/3	20.6	8	50
6/4	20.6	8	50
8/6 - 6/4	21.9	9	25
8/6	21.9	9	25
10/8	25.5	11	25
12/10	27	13	25
15/12.5	33.5	16	25

1200

RACCORDO A T MASCHIO CONICO - TEE MALE ADAPTOR (TAPER) - CENTRE LEG

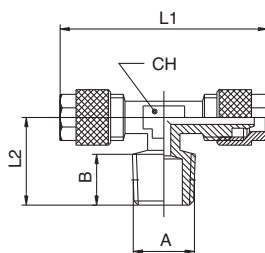

Tube/Tube	A	B	L1	L2	CH	Conf. Pack.
4/2.7 - 1/8		7.5	37	15.5	8	50
5/3 - 1/8		7.5	39	15.5	8	50
6/4 - 1/8		7.5	39	15.5	8	50
6/4 - 1/4		11	41.2	19	8	25
8/6 - 1/8		7.5	39.8	16.5	9	25
8/6 - 1/4		11	43.8	20.5	9	25
10/8 - 1/8		7.5	48	19	11	25
10/8 - 1/4		11	48	22	11	25
10/8 - 3/8		11.5	51	22	11	25
12/10 - 3/8		11.5	54	22.5	14	25
15/12.5 - 1/2		14	63	28	16	25

1210

RACCORDO A T ORIENTABILE MASCHIO CONICO - ORIENTING TEE MALE ADAPTOR (TAPER) - CENTRE LEG

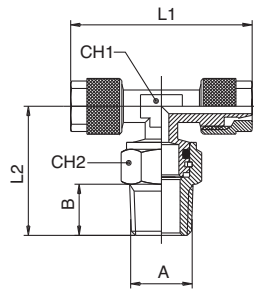

Tubo/Tube	A	B	L1	L2	CH1	CH2	Conf. Pack.
6/4 - 1/8	7.5	41.2	22.5	8	13	25	
6/4 - 1/4	11	41.2	28	8	15	25	
8/6 - 1/8	7.5	43.2	24.5	9	13	25	
8/6 - 1/4	11	43.2	29.5	9	15	25	
10/8 - 1/4	11	48	29.5	11	15	25	

1215

RACCORDO A T ORIENTABILE MASCHIO CILINDRICO - ORIENTING TEE MALE ADAPTOR (PARALLEL) - CENTRE LEG

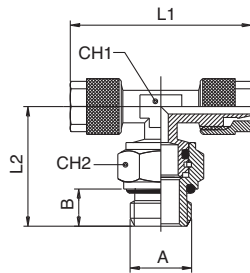

Tubo/Tube	A	B	L1	L2	CH1	CH2	Conf. Pack.
6/4 - 1/8	6	41.2	22	8	13	25	
6/4 - 1/4	8	41.2	26	8	16	25	
8/6 - 1/8	6	43.2	24	9	13	25	
8/6 - 1/4	8	43.2	27.5	9	16	25	
10/8 - 1/8	6	48	22.5	11	13	25	
10/8 - 1/4	8	48	27.5	11	16	25	

1220

RACCORDO A T MASCHIO LATERALE CONICO - TEE MALE ADAPTOR (TAPER) - OFF SET LEG

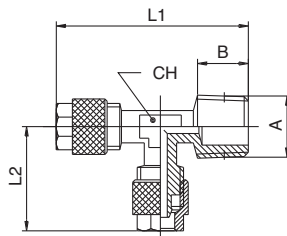

Tubo/Tube	A	B	L1	L2	CH	Conf. Pack.
5/3 - 1/8	7.5	36.7	20.6	8	50	
6/4 - 1/8	7.5	36.7	20.6	8	25	
6/4 - 1/4	11	40.2	20.6	8	25	
8/6 - 1/8	7.5	38	21.9	9	25	
8/6 - 1/4	11	41.5	21.9	9	25	
10/8 - 1/8	7.5	40	25.5	11	25	
10/8 - 1/4	11	43	25.5	11	25	
10/8 - 3/8	11.5	44	25.5	11	25	
12/10 - 3/8	11.5	48.5	28	13	25	
15/12.5 - 1/2	14	57.5	32.5	16	25	

1230

RACCORDO A T INTERMEDIO - TEE CONNECTOR

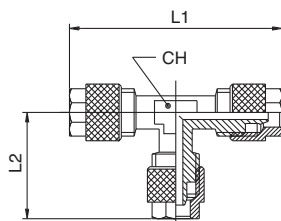

Tubo/Tube	L1	L2	CH	Conf. Pack.
4/2.7	40	20.5	8	50
5/3	41.2	20.6	8	50
6/4	41.2	20.6	8	25
8/6 - 6/4	43.8	20.6	9	25
8/6	43.8	21.9	9	25
10/8 - 6/4	51	20.6	11	25
10/8 - 8/6	51	21.9	11	25
10/8	51	25.5	11	25
12/10	54	28	13	25
15/12.5	63	32.5	16	25

1300

RACCORDO A CROCE INTERMEDIO - EQUAL CROSS CONNECTOR

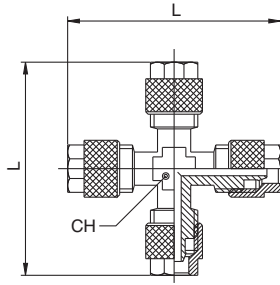

Tubo/Tube	L	CH	Conf. Pack.
5/3	41.6	8	50
6/4	41.6	8	25
8/6	44.4	9	25
10/8	49	11	25
12/10	58	13	25
15/12.5	64	17	25



COME ORDINARE

Art. 51410 - Art. 51420 - Art. 51430

Questi articoli vengono forniti completi di rondelle in PA66 Art. 1610 oppure in alluminio Art. 1600.

Sull'ordine quindi specificare il materiale delle rondelle mediante una descrizione.

DOVE NON DIVERSAMENTE SPECIFICATO VERRANNO FORNITE RONDELLE IN PA66 ART. 1610.

HOW TO ORDER

Art. 51410 - Art. 51420 - Art.51430

These articles are supplied with PA66 washers Art. 1610 or aluminium washers Art. 1600.

So, on the order You have to specify which kind of washers You wish to have, using a description.

IF NOT SPECIFIED WE WILL SUPPLY THE PA66 WASHERS ART. 1610

51420

VITE CAVA DOPPIA - BANJO STEM DOUBLE

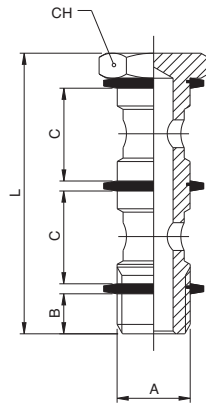

A	B	C	L	CH	Conf. Pack.
1/8	6	15	44.5	14	25
1/4	8	17	50.5	17	25
3/8	9	20	58	19	25
1/2	10	24	68	24	25
M12x1.5	8	17	50.5	17	25

QUESTO ARTICOLO VIENE FORNITO COMPLETO DI RONDELLE IN PA66 ART. 1610.
THIS ITEM WILL BE SUPPLIED WITH THE PA66 WASHERS ART. 1610.



5 1 4 2 0

1/4

PA66

CODICE ARTICOLO
ARTICLE CODE

MISURA
SIZE

TIPO RONDELLE
TYPE OF WASHERS

Rondella PA66 Art. 1610
PA66 Washer Art. 1610



Su richiesta / if required

Rondella ALLUMINIO Art. 1600
ALUMINIUM Washer Art. 1600



51410

VITE CAVA SINGOLA - BANJO STEM SINGLE

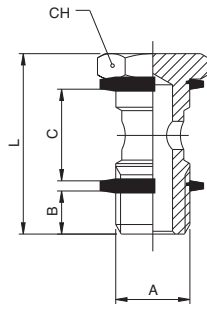

A	B	C	L	CH	Conf. Pack.
M5	4	12.5	22	8	25
M6	5	12.5	23	8	25
1/8	6	15	28	14	25
1/4	8	17	32	17	25
3/8	9	20	36	19	25
1/2	10	24	42	24	25
*M12x1.5	8	17	32	17	25

QUESTO ARTICOLO VIENE FORNITO COMPLETO DI RONDELLE IN PA66 ART. 1610.
THIS ITEM WILL BE SUPPLIED WITH THE PA66 WASHERS ART. 1610.

*CON QUESTA VITE UTILIZZARE GLI ANELLI ORIENTABILI DA 1/4.
*WITH THIS BANJO STEM USING 1/4 ORIENTING BANJO BODY.



51420

VITE CAVA DOPPIA - BANJO STEM DOUBLE

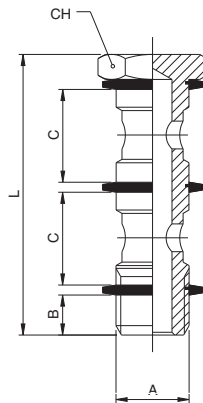

A	B	C	L	CH	Conf. Pack.
1/8	6	15	44.5	14	25
1/4	8	17	50.5	17	25
3/8	9	20	58	19	25
1/2	10	24	68	24	25
*M12x1.5	8	17	50.5	17	25

QUESTO ARTICOLO VIENE FORNITO COMPLETO DI RONDELLE IN PA66 ART. 1610.
THIS ITEM WILL BE SUPPLIED WITH THE PA66 WASHERS ART. 1610.

*CON QUESTA VITE UTILIZZARE GLI ANELLI ORIENTABILI DA 1/4.
*WITH THIS BANJO STEM USING 1/4 ORIENTING BANJO BODY.



51430

VITE CAVA TRIPLA - BANJO STEM TRIPLE

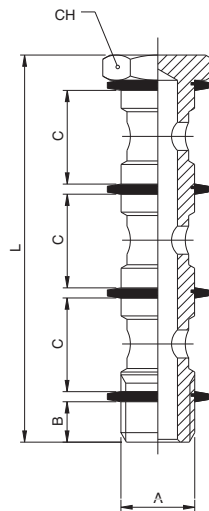

A	B	C	L	CH	Conf. Pack.
1/8	6	15	61	14	25
1/4	8	17	69	17	25
3/8	9	20	80	19	25
1/2	10	24	94	24	10

QUESTO ARTICOLO VIENE FORNITO COMPLETO DI RONDELLE IN PA66 ART. 1610.
THIS ITEM WILL BE SUPPLIED WITH THE PA66 WASHERS ART. 1610.



51440

VITE CAVA SINGOLA MASCHIO - FEMMINA - MALE - FEMALE BANJO STEM SINGLE

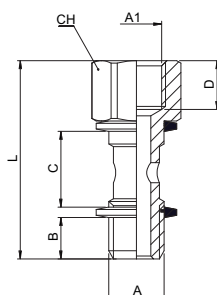

A	A1	B	C	D	L	CH	Conf. Pack.
1/8	1/8	6	15	8.5	34.5	14	25
1/4	1/4	8	17	11	40.5	17	25
3/8	3/8	9	20	12	45.5	19	25

QUESTO ARTICOLO VIENE FORNITO COMPLETO DI RONDELLE IN PA66 (ART. 1610).
THIS ITEM WILL BE SUPPLIED WITH THE PA66 WASHERS (ART. 1610).

NEW



1500

ANELLO ORIENTABILE A L - SINGLE BANJO BODY

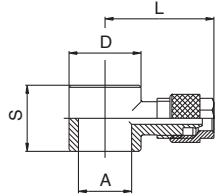

Tubo/Tube	A	D	S	L	Conf. Pack.
4/2.7 - M5	5.1	9	12.5	21.5	50
4/2.7 - M6	6.1	9	12.5	21.5	10
4/2.7 - 1/8	10	14	15	22.5	50
5/3 - M5	5.1	9	12.5	22	50
5/3 - 1/8	10	14	15	22.5	50
6/4 - M5	5.1	9	12.5	22	50
6/4 - M6	6.1	9	12.5	22	10
6/4 - 1/8	10	14	15	23	50
6/4 - 1/4	13.3	18	17	25	50
6/4 - 3/8	16.7	21	20	27	25
8/6 - 1/8	10	14	15	24.5	50
8/6 - 1/4	13.3	18	17	26	25
8/6 - 3/8	16.7	21	20	27	25
8/6 - 1/2	21	26	24	31	25
10/8 - 1/8	10	14	15	27.5	25
10/8 - 1/4	13.3	18	17	27.5	25
10/8 - 3/8	16.7	21	20	30.5	25
10/8 - 1/2	21	26	24	34	25
12/10 - 3/8	16.7	21	20	31.5	25
12/10 - 1/2	21	26	24	35	25
15/12.5 - 1/2	21	26	24	36.5	25

1510

ANELLO ORIENTABILE A T - DOUBLE BANJO BODY

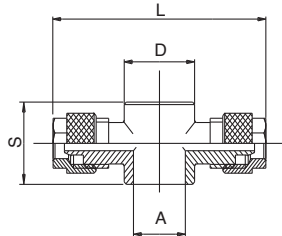

Tubo/Tube	A	D	S	L	Conf. Pack.
4/2.7 - M5	5.1	9	12.5	43	50
4/2.7 - 1/8	10	14	15	43	50
5/3 - M5	5.1	9	12.5	43	50
5/3 - 1/8	10	14	15	46.6	50
6/4 - M5	5.1	9	12.5	43	50
6/4 - 1/8	10	14	15	46.6	50
6/4 - 1/4	13.3	18	17	50.6	25
6/4 - 3/8	16.7	21	20	53.6	25
8/6 - 1/8	10	14	15	49.4	25
8/6 - 1/4	13.3	18	17	55.2	25
8/6 - 3/8	16.7	21	20	55	25
8/6 - 1/2	21	26	24	61	25
10/8 - 1/8	10	14	15	53	25
10/8 - 1/4	13.3	18	17	59	25
10/8 - 3/8	16.7	21	20	61	25
10/8 - 1/2	21	26	24	66	25
12/10 - 3/8	16.7	21	20	63	25
12/10 - 1/2	21	26	24	70	25
15/12.5 - 1/2	21	26	24	73	25

LG 410

VITE CAVA SINGOLA SERIE LEGGERA - BANJO STEM SINGLE LIGHT

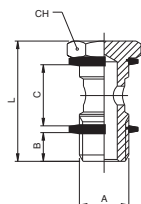

A	B	C	L	CH	Conf. Pack.
M5	3.5	9	18	8	25
M6	4	9	19	8	25

QUESTO ARTICOLO VIENE FORNITO COMPLETO DI RONDELLE IN PA66 ART. 1610.
THIS ITEM WILL BE SUPPLIED WITH THE PA66 WASHERS ART. 1610.

LG 500

ANELLO ORIENTABILE SERIE LEGGERA - SINGLE BANJO BODY LIGHT

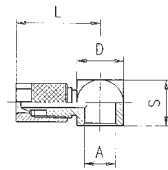

Tubo/Tube	A	D	S	L	Conf. Pack.
4/2.7 - M5	5.1	9	9	17	50
4/2.7 - M6	6.1	9	9	17	50
5/3 - M5	5.1	9	9	17	50
6/4 - M5	6.1	9	9	16.5	50
6/4 - M6	5.1	9	9	16.5	50

1600

RONDELLA IN ALLUMINIO - ALUMINIUM WASHER

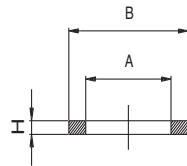

Misura/Size	A	B	H	Conf. Pack.
M5	5.2	8	1	25
1/8	10	14	1.5	25
1/4	13.5	18	1.5	25
3/8	16.8	21	1.5	25
1/2	21.1	26	1.5	25
M12	12.5	18	1.5	25

1610

RONDELLA DENTELLATA IN PA66 - PA66 NOTCHED-WASHER

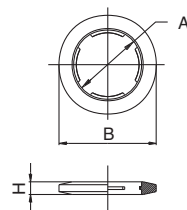

Misura/Size	A	B	H	Conf. Pack.
M3	2.5	5.5	0.5	25
M5	5.2	8	1	25
M6	6.1	9	1.3	25
1/8	10	14	1.5	25
1/4	13.5	18	1.5	25
3/8	16.8	21	1.5	25
1/2	21.1	26	2	25
3/4	27	32	2.5	25
1"	34	41	2.5	25

1700

DADO DI BLOCCAGGIO - LOCKING NUT

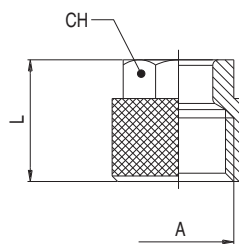

Tubo/Tube	A	L	CH	Conf. Pack.
4/2.7 - M6x0.5		9	7	50
5/3 - M7x0.75		11	8	50
6/4 - M8x0.75		11	8	50
6/4 - M10x1		11	10	50
8/6 - M12x1		11.5	12	50
10/8 - M14x1		13.5	14	50
12/10 - M16x1		15	15	50
15/12.5 - M20x1		16	19	50

1710

DADO DI BLOCCAGGIO CON MOLLA - LOCKING NUT WITH SPRING

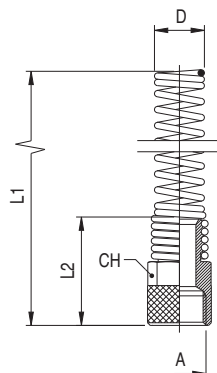

Tubo/Tube	A	D	L1	L2	CH	Conf. Pack.
6/4 - M10x1	9.4	93	20	11		25
8/6 - M12x1	11.4	98.5	21	13		25
10/8 - M14x1	13.4	107	24	14		25
12/10 - M16x1	16	116.5	27.5	17		25

1750

TAGLIATUBO IN PLASTICA - PLASTIC PIPE CUTTER

NEW

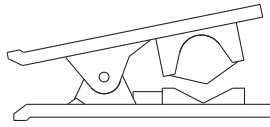

	Conf.
	Pack.
	10